

DATE: 08/21/2023

ELMHURST NEIGHBORHOOD ASSOCIATION  
APPLICATION FOR ALTERATION APPROVAL

\*NO ALTERATIONS MAY BEGIN UNTIL APPROVAL IS GRANTED\*

William Millar

1. Homeowner Name and Signature 202 309 5685  
Phone Number(s)
2. 351 BOUNDARY ST SEWICKLEY PA  
Address of home where alteration will occur
3. N/A  
Mailing address of homeowner (if different)
4. Type of alteration:  
Landscape \_\_\_\_\_ Building Exterior \_\_\_\_\_ Other (Please specify): DRAINAGE IMPROVEMENT
5. Location of alteration in or around your home:  
\_\_\_\_\_ Front X Side \_\_\_\_\_ Rear \_\_\_\_\_ Other  
If other, please specify: \_\_\_\_\_
6. Scope of Alteration: Please explain in detail what you are requesting permission to do - include approximate dimensions if appropriate:  
Alleviate wet basement issue by construction of  
additional French drain in affected side yard.  
Application of waterproofing to specific area of  
foundation  
Restoration of all areas affected
7. Materials to be used: Describe the type of materials (or shrubs) to be installed and/or removed and quantities of each material:  
See attached proposal dated 08/07/2023  
from Eichenlaub Landscaping

(Continued on next page)

8. Effect on the Existing Area: Explain if any existing elements will be affected by this alteration (will existing shrubs be moved, or part of existing porches be dismantled, etc.):

no alteration to buildings or shrubs

9. Effect of alteration on neighbors to either side of your home:

n/a

10. Signature of nearest neighbors to the right and left of your home signifying that, as a courtesy, the adjoining neighbors have been made aware of this alteration request.

x Charles Sudo

x 8/22/23 Verbal + email approval  
by Jane Cowden

NOTE: If you are unable to obtain the signatures of one or both of your neighbors, you must explain the reason below:

11. If applicable, please attach a drawing showing all existing elements, including shrubs and porches in solid lines and proposed alterations in dotted lines. Include the first three feet of your neighbors' homes and yard in the drawing. Show distance from nearest existing elements to proposed additions or alterations. A plot plan must also be included for requests other than painting.

12. Expected start date: following proposal approval Completion date: 1-2 days following start

13. Additional Notes:

**Please attach drawings, brochures, pictures, etc. to this form.**

APPLICANT: PLEASE DO NOT WRITE BELOW THIS LINE.

Approved By: \_\_\_\_\_

Title: \_\_\_\_\_

Date: \_\_\_\_\_

August 7, 2023

Ms. Barbara Millar  
351 Boundary Street  
Sewickley, PA 15143

**Landscape Drainage Proposal**

We are pleased to propose the following:

**Drainage Work (Near Irrigation Valve Box) and Waterproofing of Wall Section**

- Excavate down to a depth needed to depth of I-beam location in basement.
- Use waterproofing compound to waterproof the area around the I-beam.
- Remove and dispose of vegetation (lawn area) as needed to allow for new drainage installation.
- Excavate up to a 20' long trench (10' on either side of the proposal 9" NDS Drainage Catch Basin) with an average depth of 12 inches, to allow for burial of new 4" corrugated drainpipe.
- Tie 4" solid corrugated drainpipe into the existing drainage pipe system in place.
- Provide and install one (1) 9" NDS square rigid plastic yard drain (catch basin) to an adequate depth to catch excessive water at the surface.
- Restore all areas disturbed by trenching activities by finish grading, laying down landscape filter fabric and surfacing the area with gravel in sizes ranging from 2"-6".
- **Note:** Since underground water activity cannot be viewed and its dynamics fully understood, Eichenlaub cannot guarantee this solution will completely solve this drainage issue.

**Cost of the Drainage Work and Water Proofing of I-Beam Area with Gravel Surface: \$3,525.00**

Payment terms: A deposit of \$1,000.00 is due with a signed copy of the agreement, and the balance is due upon progress requisitions or substantial completion of the work. Payment for all Special-Order Materials is due with a signed copy of the agreement.

Please do not hesitate to call me should you have any questions.

Yours truly,



Kevin Anthony Prall  
Landscape Consultant

*To learn more about our firm, please visit us online at [www.eichenlaub.com](http://www.eichenlaub.com). This proposal is based on Eichenlaub, LLC's standard terms and conditions, and unless otherwise noted or required by law, you agree to obtain all necessary permits in connection with this proposal. We*

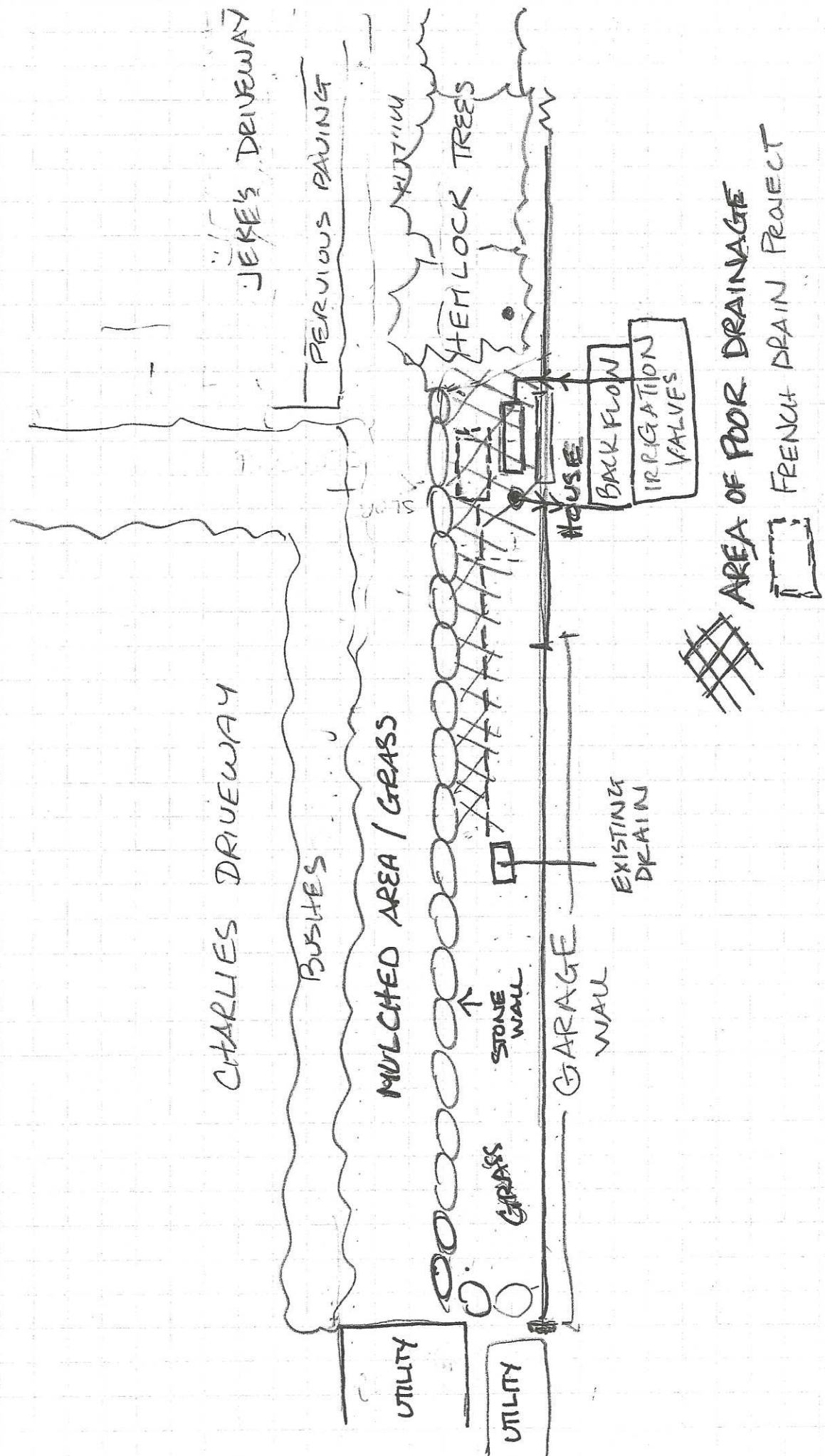

CHARLIE'S DRIVEWAY

JERKE'S DRIVEWAY

BUSHES

MULCHED AREA / GRASS

GRASS

STONE WALL

GARAGE WALL

EXISTING DRAIN

HOUSE

BACKFLOW IRRIGATION VALVES

FRENCH DRAIN PROJECT

AREA OF POOR DRAINAGE

HEMLOCK TREES

MULCH

PERVIOUS PAVING

UTILITY

UTILITY







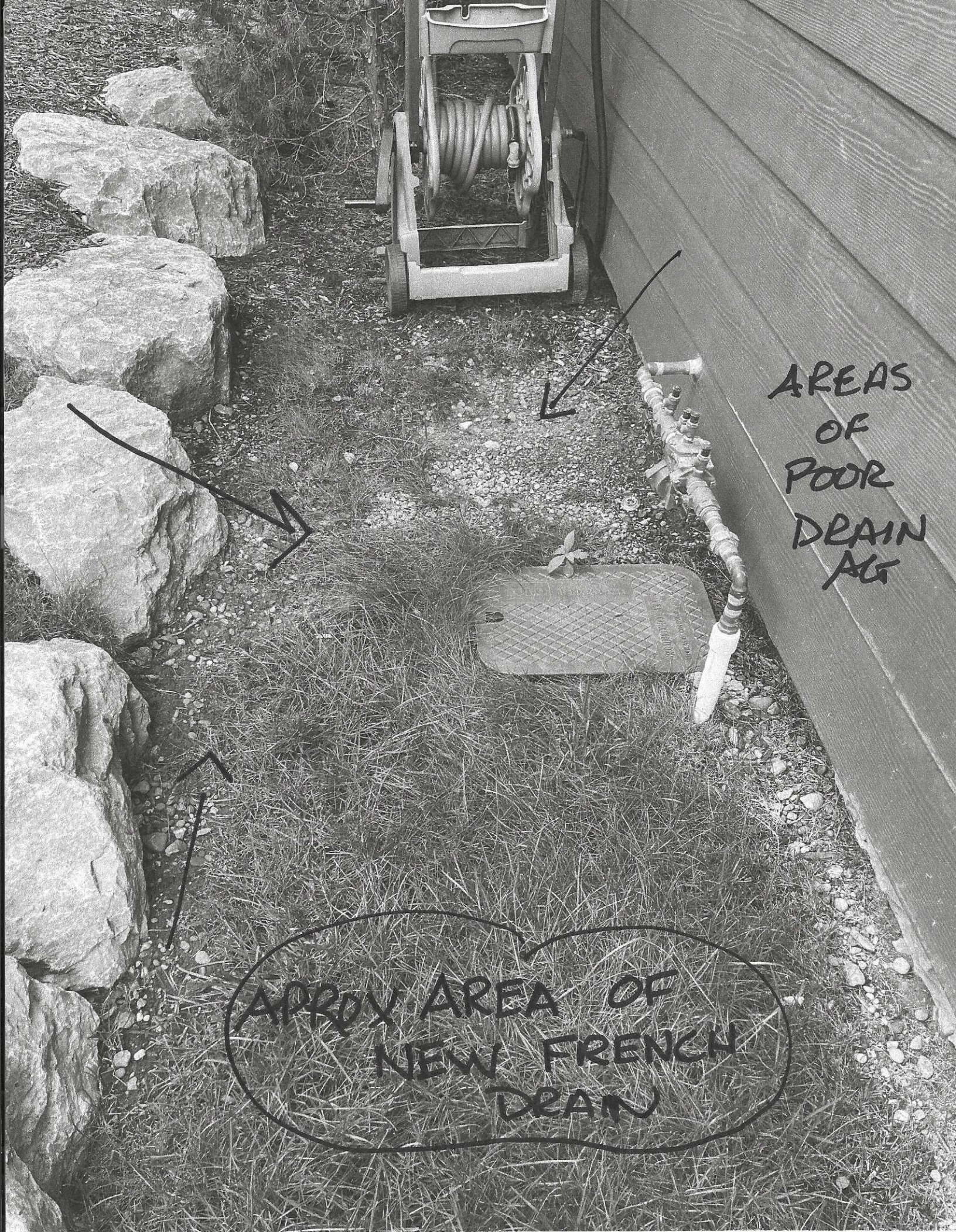

AREAS  
OF  
POOR  
DRAIN  
AGE

APPROX AREA OF  
NEW FRENCH  
DRAIN





NEW  
DRAIN  
LOCATION

CURRENT  
DRAIN